

SURVEY PLAT & LEGAL DESCRIPTION
APPROVED PER R.C. 315.251
R.S.
OFFICE OF THE
GEAUGA COUNTY ENGINEER
10/17/02
Revised

SURVEY PLAT & LEGAL DESCRIPTION
APPROVED PER R.C. 315.251
OFFICE OF THE
GEAUGA COUNTY ENGINEER

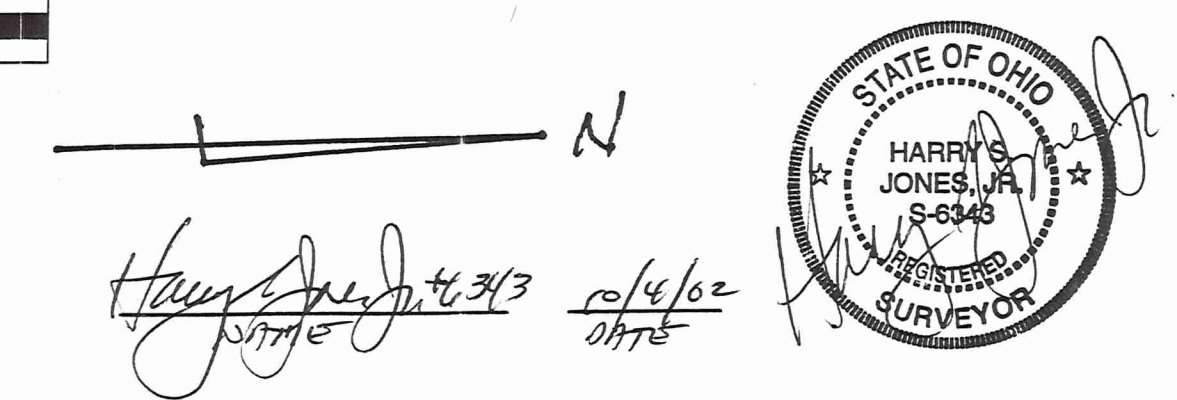
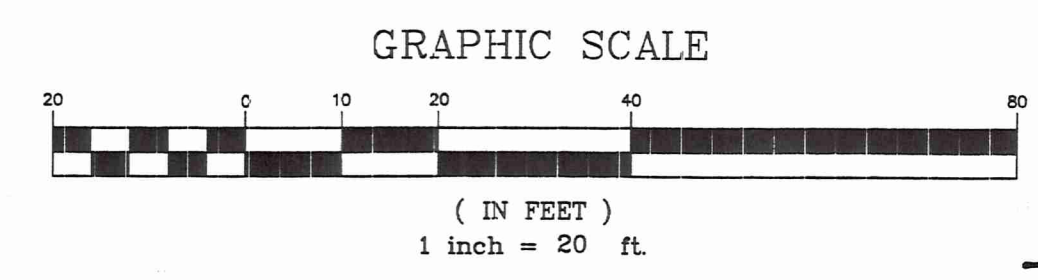

WILLIAM R. & JOAN WEBER
VOL. 621-PG. 1121
11-362780

ORIGINAL 1.0011 AC.
PARCEL A - 0.7186 AC.
BALANCE 0.2825 AC.

WILLIAM R. & JOAN WEBER
VOL. 621-PG. 1123
11-362770

MICHAEL R. & CARYL L. BERGMAN
VOL. 733-PG. 1853
11-206200

PARCEL "A"
0.7186 AC.

ROBERT WANTZ
VOL. 1144-PG. 1004
11-199810
11-199820

William & Joan Weber
VOL. 1446-PG. 345

MAYFIELD ROAD - 60'

VALLEY VIEW DRIVE - 50'

This map was prepared and the premises surveyed in accordance with chapter 4733-37 of the Ohio Administrative Code.

REV. NO.	DESCRIPTION	DATE	BY	CHK'D
1	REVISIONS PER COUNTY ENGINEER	10/14/02	HJ	HJ

bj BABCOCK, JONES AND ASSOCIATES, INC
CIVIL ENGINEERS - SURVEYORS - LAND PLANNERS
PAINESVILLE OHIO 44077

DATE	3/8/02
DESIGN BY	H.J.
DRAWN BY	M.M.
APPROVED BY	H.J.

PLAT OF SURVEY
FOR
ROBERT WANTZ
LOT No. 35, TRACT No. 3
CHESTER TOWNSHIP GEAUGA COUNTY OHIO

SCALE	1"=20'
JOB NO	02-025
SHEET	1
OF	1

CHE00159

CHE00159

Wantz
Picked up 10-15-02
11-389250
Vol. 1743-Pg. 3244



BABCOCK - JONES
CIVIL ENGINEERS AND SURVEYORS

1924 MENTOR AVE., PAINESVILLE, OHIO 44077 PHONE (440) 357-1811 FACSIMILE (440) 357-9173

October 3, 2002

REVISED LEGAL DESCRIPTION OF PARCEL 'A' FOR ROBERT WANTZ.

Situated in the Township of Chester, County of Geauga, and State of Ohio and known as being a part of Lot No. 35, Tract No. 3 is said Township and being further bounded and described as follows;

Beginning at a 1" iron pipe found at the intersection of the southeasterly corner of land conveyed to Michael and Caryl Bergman by deed recorded in Volume 733, Page 1853 of Geauga County Deed Records and the westerly right-of-way line of Valley View Drive (50 feet wide;

COURSE I: Thence North 85°33'49" West along the southerly line of Michael and Caryl Bergman a distance of 207.19 feet to a 5/8" x 30" iron pin set and capped Babcock, Jones & Associates, Inc.;

COURSE I: Thence South 4°22'24" West a distance of 151.13 feet to a 5/8" x 30" iron pin set and capped Babcock, Jones & Associates, Inc. at the northwesterly corner of land conveyed to Robert Wantz by deed recorded in Volume 1144, Page 1004 of Geauga County Deed Records;

COURSE III: Thence South 85°34'49" East along the northerly line and to the northeasterly corner of Robert Wantz a distance of 207.03 feet to a 5/8" x 30" iron pin set and capped Babcock, Jones & Associates, Inc. on the westerly right-of-way line of Valley View Drive;

COURSE IV: Thence North 4°26'10" East along the westerly right-of-way line of Valley View Drive a distance of 151.07 feet to the place of beginning and containing 0.7186 of an acre of land as surveyed and described by Harry S. Jones, Registered Surveyor No. 6343 in March, 2002.

Bearings are based upon the centerline of Valley View Drive being North 4°26'10' East and are used to describe angles only.

Previous deed - Volume 621, Page 1123.

SURVEY PLAT & LEGAL DESCRIPTION
APPROVED PER R.C. 315.251
R.S.
10/7/02
OFFICE OF THE
GEAUGA COUNTY ENGINEER

Harry S. Jones, Jr. #6343 10/4/02



CHE 00159

11-362770

Vol. 1743-Pg. 3248



BABCOCK - JONES

CIVIL ENGINEERS AND SURVEYORS

1924 MENTOR AVE., PAINESVILLE, OHIO 44077 PHONE (440) 357-1811 FACSIMILE (440) 357-9173

October 3, 2002

REVISED LEGAL DESCRIPTION OF BALANCE FOR ROBERT WANTZ.

Situated in the Township of Chester, County of Geauga, and State of Ohio and known as being a part of Lot No. 35, Tract No. 3 is said Township and being further bounded and described as follows;

Beginning at a 1" iron pipe found at the intersection of the southeasterly corner of land conveyed to Michael and Caryl Bergman by deed recorded in Volume 733, Page 1853 of Geauga County Deed Records and the westerly right-of-way line of Valley View Drive (50 feet wide;

Thence North 85°33'49" West along the southerly line of Michael and Caryl Bergman a distance of 207.19 feet to a 5/8" x 30" iron pin set and capped Babcock, Jones & Associates, Inc., to the principal place of beginning;

COURSE I: Thence North 85°33'50" West along the southerly line and to the southwesterly corner of Michael and Caryl Bergman a distance of 81.50 feet to a 1" iron pipe found in concrete;

COURSE II: Thence South 4°19'57" West a distance of 151.07 feet to a 1" iron pipe found in concrete at the northwesterly corner of land conveyed to William and Joan Weber by deed recorded in Volume 1446, Page 345 of Geauga County Deed Records;

COURSE III: Thence South 85°31'27" East along the northerly line and to the northeasterly corner of William and Joan Weber a distance of 81.39 feet to a 5/8" x 30" iron pin set and capped Babcock, Jones & Associates, Inc.,

COURSE IV: Thence North 4°22'24" East a distance of 151.13 feet to the principal place of beginning and containing 0.2825 of an acre of land as surveyed and described by Harry S. Jones, Registered Surveyor No. 6343 in March, 2002.

Bearings are based upon the centerline of Valley View Drive being North 4°26'10" East and are used to describe angles only.

Previous deed - Volume 621, Page 1123.

SURVEY PLAT & LEGAL DESCRIPTION
APPROVED PER R.C. 315.251
R.S.
10/7/02
OFFICE OF THE
GEAUGA COUNTY ENGINEER

Harry S. Jones, Jr. #6343 10/4/02

